

# NEW MEXICO FLOODPLAIN MANAGERS ASSOCIATION

Brendan Baird  
Bosque School  
Albuquerque

# 2016 FLOOD AWARENESS CALENDAR

1st Place



Sean Cervantes  
Bosque School  
Albuquerque

2nd Place

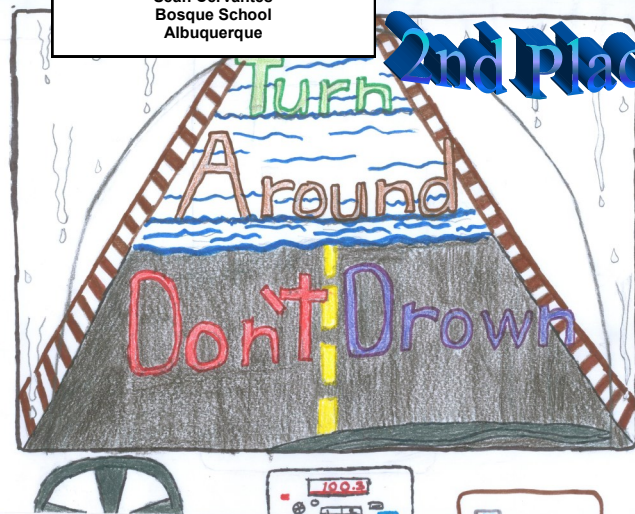

3rd Place

Jaxon Odom  
Clovis Christian School  
Clovis

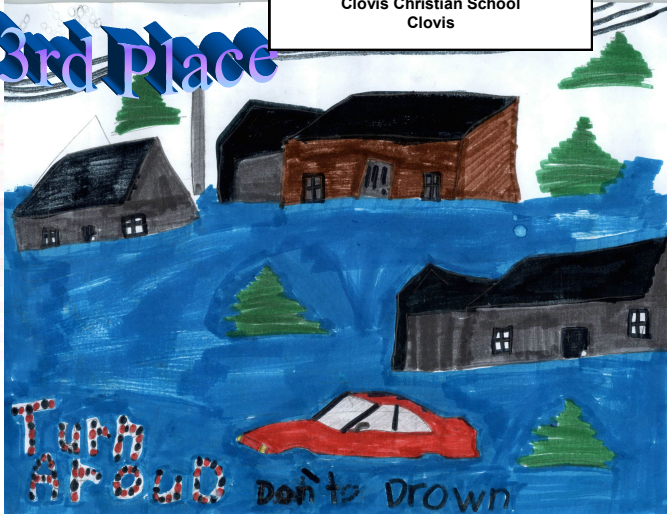



Do you really know  
how deep and fast  
the water is?

Turn Around  
Don't Drown

For important, life-saving information please visit  
<http://tadd.weather.gov>

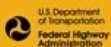

American Association of  
Motor Vehicle Administrators



## FOLLOW THESE SAFETY RULES

If flooding occurs, **get to higher ground**. Get out of areas subject to flooding. These include dips, low spots, canyons, and normally dry washes.

Avoid roads already flooded.

Road may be washed out under flood waters. **Turn Around Don't Drown** when you encounter a flooded road.

If heavy rain is forecast or occurring, move your camp site and vehicle away from streams and washes.

Be especially cautious when driving at night when it is harder to recognize flood dangers.

FLOODING AHEAD  
TURN AROUND  
DON'T DROWN

Many drivers over estimate their ability to navigate flooded roads, putting too much stock in their "heavy" vehicles.

In reality, most motorists **lose control** of their vehicles, including SUVs, in **just six inches of water**, while 18-24 inches of moving water will force a vehicle off the road.

The menace is buoyant force. When the buoyant force is greater than the vehicle's weight, the vehicle will move with the moving water.

Besides the buoyant force, erosion is another significant concern. Moving water is very powerful and can undermine the integrity of a road. A motorist will be unaware he is driving into a scoured out section of the road.

### Forces on Vehicles From High Water

The car will be carried when:  
Buoyancy Force **Greater Than** Vehicle Weight



Nearly half of all flood fatalities are vehicle related



# *New Mexico Floodplain Managers Association*

P.O. Box 3924—Roswell, NM 88202  
575-937-1691  
nmcfm@cableone.net

If you have an interest in flood hazard awareness, mitigation, and disaster preparedness, please look at our website and plan to attend our next conference. You will be surprised at what we are accomplishing.

## **SPRING 2016 WORKSHOP/CONFERENCE—SANTA FE, NEW MEXICO**

- ⇒ Conference Director—Joe Barela—[joebengineering@msn.com](mailto:joebengineering@msn.com)
- ⇒ Program Director—Eric Nemeth (Technical Track) - [eric.nemeth@aecom.com](mailto:eric.nemeth@aecom.com)
- ⇒ Program Director—Sean O'Melveny (Non-Technical Track) - [sean.omelveny@aecom.com](mailto:sean.omelveny@aecom.com)

## **FALL 2016 WORKSHOP/CONFERENCE—DEMING, NEW MEXICO**

- ⇒ Conference Director—Phil Butz—[phillipa.butz@state.nm.us](mailto:phillipa.butz@state.nm.us)

**2017 WORKSHOP/CONFERENCE**—We are looking for host communities as well as Conference Directors and Program Directors.



Like us on Facebook



Join us on LinkedIn

Check out our Web Site: [www.nmfma.org](http://www.nmfma.org)

## **NMFMA BOARD OF DIRECTORS AND COMMITTEE CHAIRS**

CHAIR	David W Turk, CFM, GISP	<a href="mailto:dave.turk@aecom.com">dave.turk@aecom.com</a>
1ST Vice Chair	Michele Truby-Tillen, CFM	<a href="mailto:mtruby@sjcounty.net">mtruby@sjcounty.net</a>
2nd Vice Chair	Curt Temple, CFM	<a href="mailto:ctemple@lincolncountynm.gov">ctemple@lincolncountynm.gov</a>
Secretary	Shawn Penman, CFM	<a href="mailto:spenman@edac.unm.edu">spenman@edac.unm.edu</a>
Treasurer	J.D. Padilla, CFM	<a href="mailto:jdpadilla@las-cruces.org">jdpadilla@las-cruces.org</a>
Region I Director	Nicole M Friedt, CFM, P.E.	<a href="mailto:Nicole.Friedt@state.nm.us">Nicole.Friedt@state.nm.us</a>
Region II Director	Paul Dugie, P.E., CFM	<a href="mailto:pauld@donaanacounty.org">pauld@donaanacounty.org</a>
Region III Director	Michael Garcia, CFM	<a href="mailto:MGarcia@rio-arriba.org">MGarcia@rio-arriba.org</a>
Region IV Director	Mike Czosnek, CFM	<a href="mailto:mczosnek@socorronm.gov">mczosnek@socorronm.gov</a>
Executive Director	Grant Pinkerton, CFM	<a href="mailto:nmcfm@cableone.net">nmcfm@cableone.net</a>
Conference Committee Chair	Mike Czosnek, CFM	<a href="mailto:mczosnek@socorronm.gov">mczosnek@socorronm.gov</a>
GIS Committee Chair	Eric Nemeth, CFM	<a href="mailto:eric.nemeth@aecom.com">eric.nemeth@aecom.com</a>
Training/Education Committee Chair	Jim Deangelo, CFM	<a href="mailto:jim.deangelo@aecom.com">jim.deangelo@aecom.com</a>



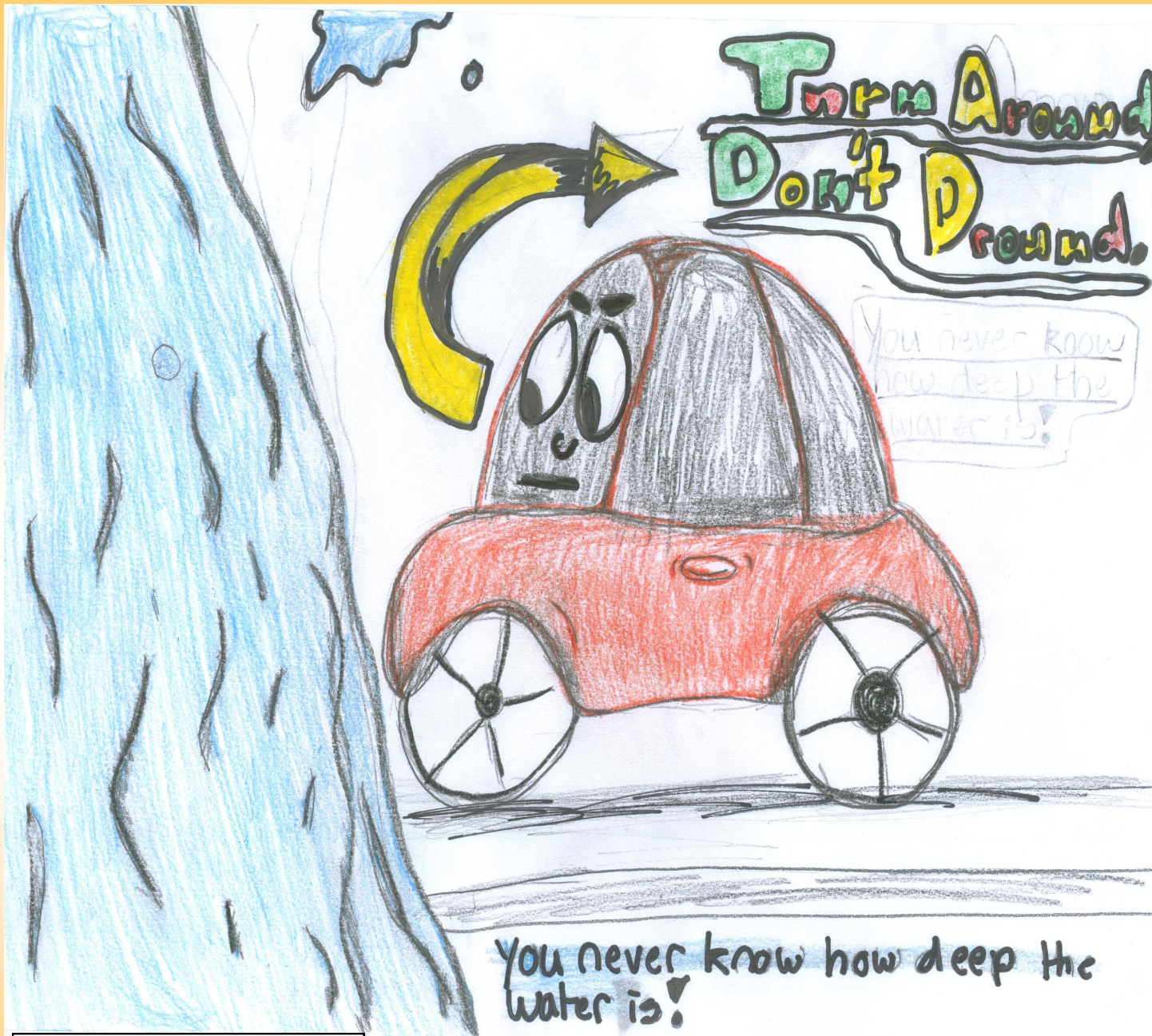

Brendan Baird  
Bosque School  
Albuquerque



# January 2016

## Schedule of Events

### [Training](#)

 [FEMA EMI](http://training.fema.gov/)  
http://training.fema.gov/

[1/4-1/7](#)  
E0317 Comprehensive Data  
Management for Hazus-MH

[1/11—1/4](#)  
E0313 Basic HAZUS—MH

Sun	Mon	Tue	Wed	Thu	Fri	Sat
					1 NEW YEARS DAY	2
3	4	5	6	7	8	9
10	11	12	13	14	15	16
17	18 Martin Luther King Day	19	20	21	22	23
24 31	25	26	27	28	29	30



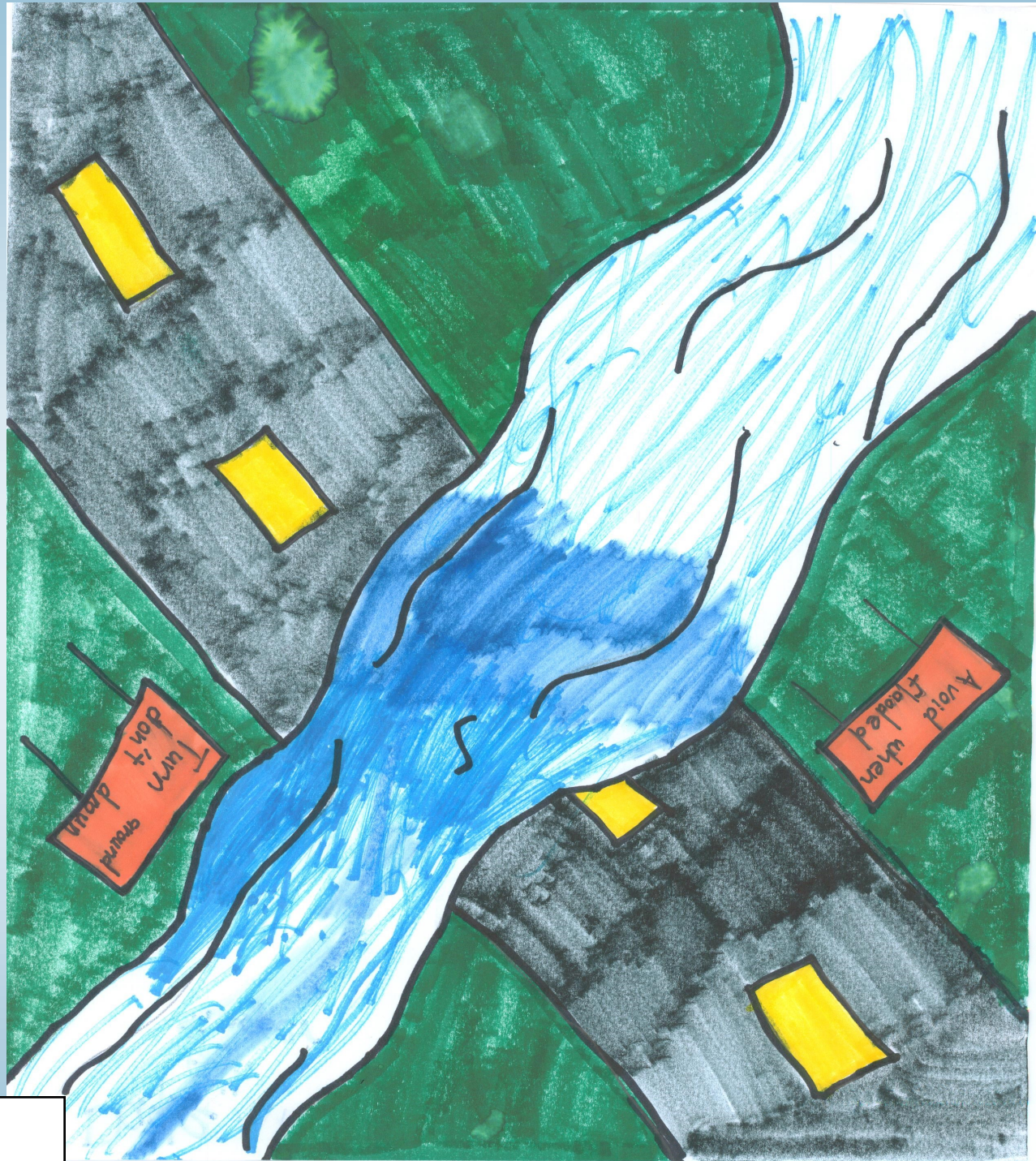

Dayle Albrecht  
Bosque School  
Albuquerque



# February 2016

## Schedule of Events

### Training

 [FEMA EMI](http://training.fema.gov/)

<http://training.fema.gov/>

2/17—2/18

E0274 National Dam Safety  
Program Technical Seminar  
(NDSPTS)

2/29—3/3

E0291 Community Dam Safety,  
Preparedness & Mitigation

Sun	Mon	Tue	Wed	Thu	Fri	Sat
	1	2 GROUNDHOG DAY	3	4	5 NATIONAL WEAR RED DAY	6
7	8 CHINESE NEW YEAR	9 MARDI GRAS	10 ASH WEDNESDAY	11	12 LINCOLN'S BIRTHDAY	13
14 VALENTINE'S DAY	15 PRESIDENTS' DAY	16	17	18	19	20
21	22	23	24	25	26	27
28	29					







# March 2016

## Schedule of Events

### Training

 [FEMA EMI](http://training.fema.gov/)  
<http://training.fema.gov/>

2/29—3/3

E0291 Community Dam Safety,  
Preparedness & Mitigation

3/7—3/10

E0273 Managing Floodplain  
Development thru the NFIP

3/21—3/24

E0296 Application of  
Hazus-MH for Risk  
Assessment

Sun	Mon	Tue	Wed	Thu	Fri	Sat
		1	2 READ ACROSS AMERICA DAY	3	4 EMPLOYEE APPRECIATION DAY	5
6	7	8	9	10	11	12
13	14	15	16	17 ST. PATRICK'S DAY	18	19
20 PALM SUNDAY MARCH EQUINOX	21	22	23	24	25 GOOD FRIDAY	26
27 EASTER	28	29	30	31		



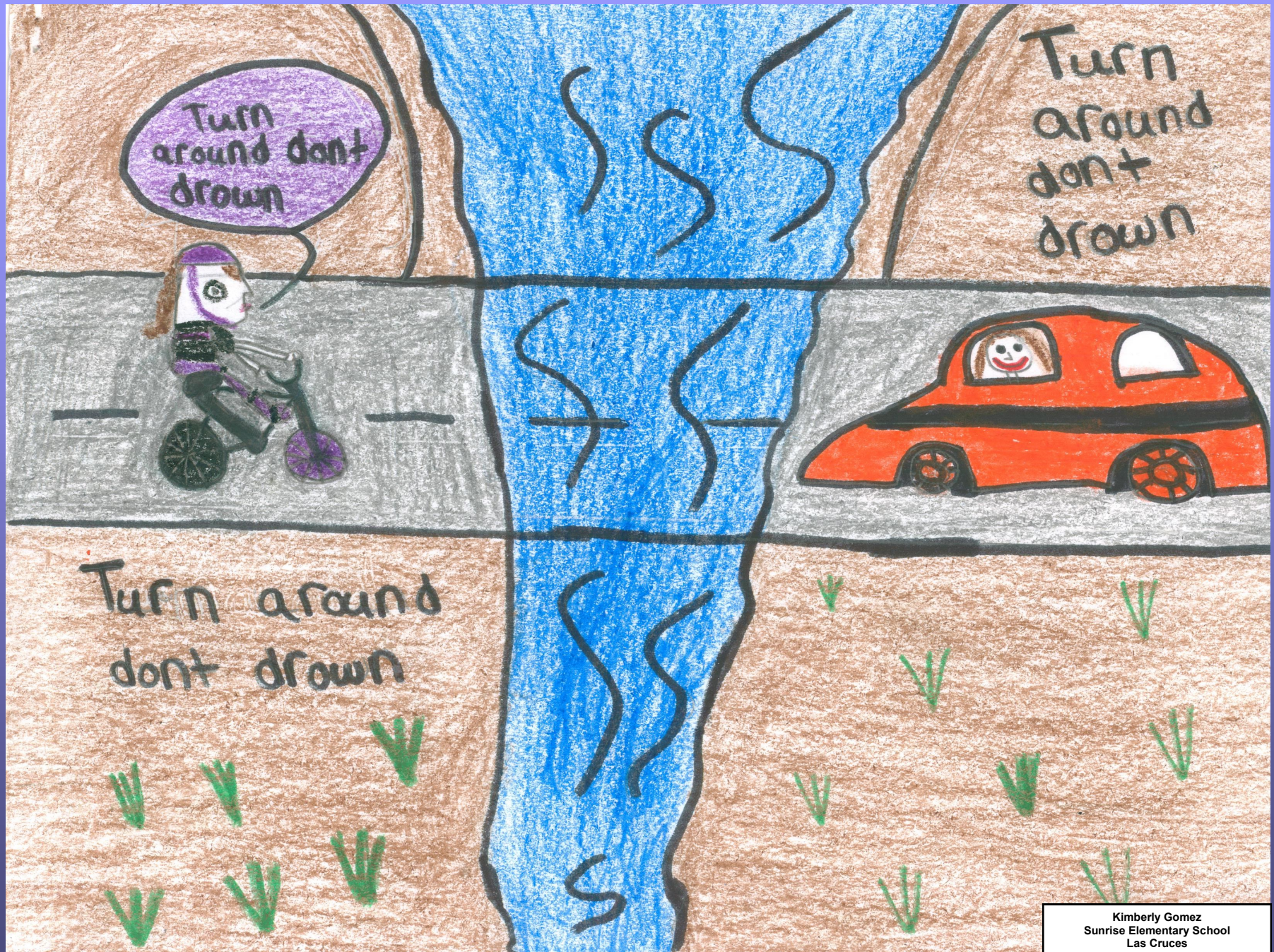



# April 2016

## Schedule of Events

### Training

 [FEMA EMI](http://training.fema.gov/)  
<http://training.fema.gov/>

4/4—4/7  
E0241 Cooperating  
Technical Partners:  
Special Topics

4/11—4/14  
E0194 Advanced  
Floodplain Management  
Concepts

4/11—4/14  
E0313 Basic Hazus-MH

4/18—4/21  
E0278 NFIP/Community  
Rating System

Sun	Mon	Tue	Wed	Thu	Fri	Sat
					1	2
3	4	5	6 NATIONAL TARTAN DAY	7	8	9
10	11	12	13 THOMAS JEFFERSON'S BIRTHDAY	14	15 TAX DAY	16
		NMFMA SPRING WORKSHOP Santa Fe—Buffalo Thunder Casino				
17	18	19 NATIONAL LIBRARY WORKERS DAY	20	21	22	23
24	25	26	27 ADMINISTRATIVE PROFESSIONALS DAY	28 TAKE OUR DAUGHTERS AND SONS TO WORK DAY	29	30



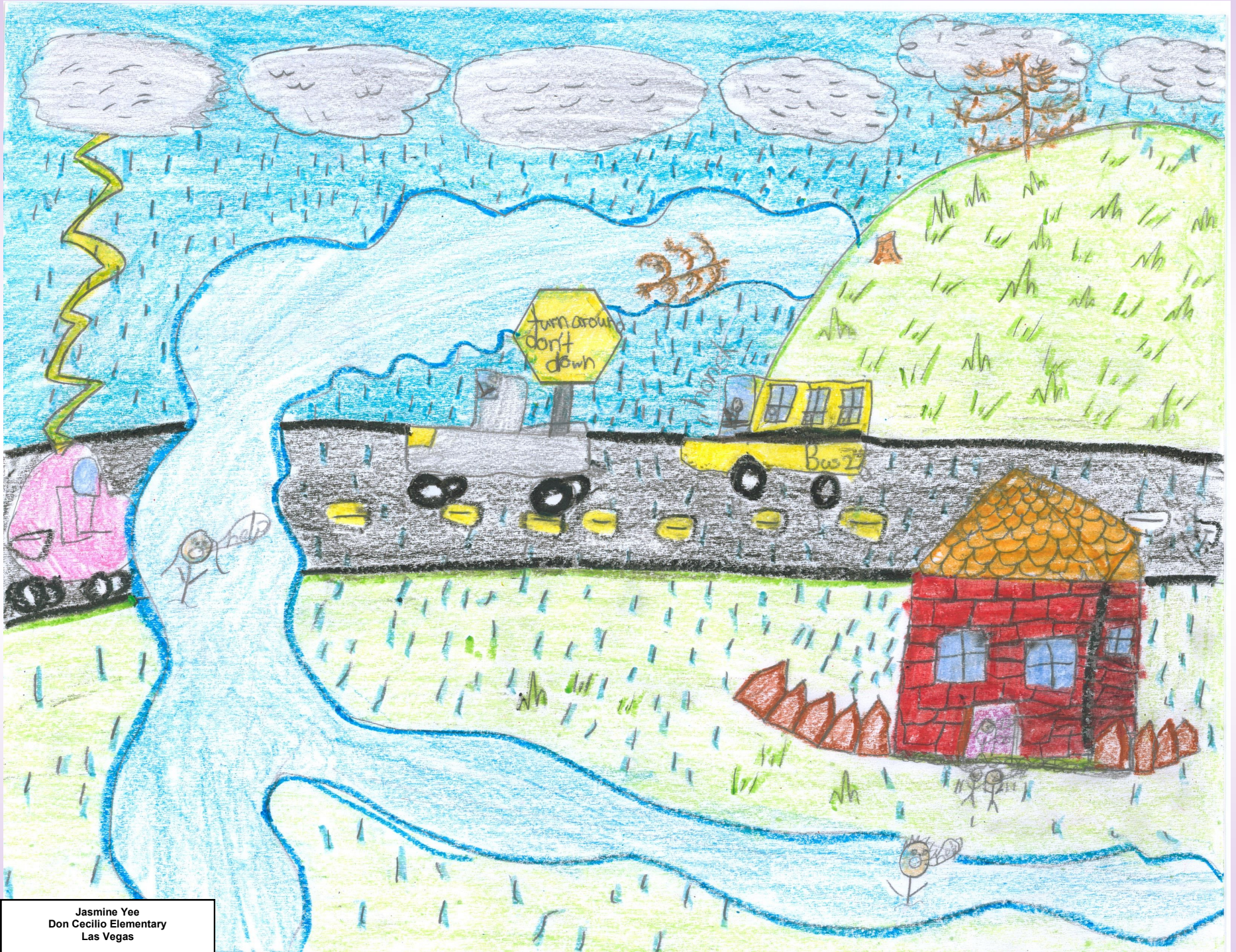

Jasmine Yee  
Don Cecilio Elementary  
Las Vegas



# May 2016

## Schedule of Events

[Training](#)

[FEMA EMI](#)

<http://training.fema.gov/>

5/2—5/5

E279 Retrofitting Floodprone  
Residential Bldgs

Sun	Mon	Tue	Wed	Thu	Fri	Sat
1 LAW DAY  LOYALTY DAY	2	3	4	5 CINCO DE MAYO  NATIONAL DAY OF PRAYER	6 NATIONAL NURSES DAY	7 NATIONAL EXPLOSIVE ORDNANCE DISPOSAL (EOD) DAY
8 MOTHER'S DAY	9	10	11	12	13	14
15 PEACE OFFICERS MEMORIAL DAY	16	17	18	19	20	21 ARMED FORCES DAY
22	23	24	25 NATIONAL MISSING CHILDREN'S DAY	26	27	28
29	30 MEMORIAL DAY	31				

2nd Place

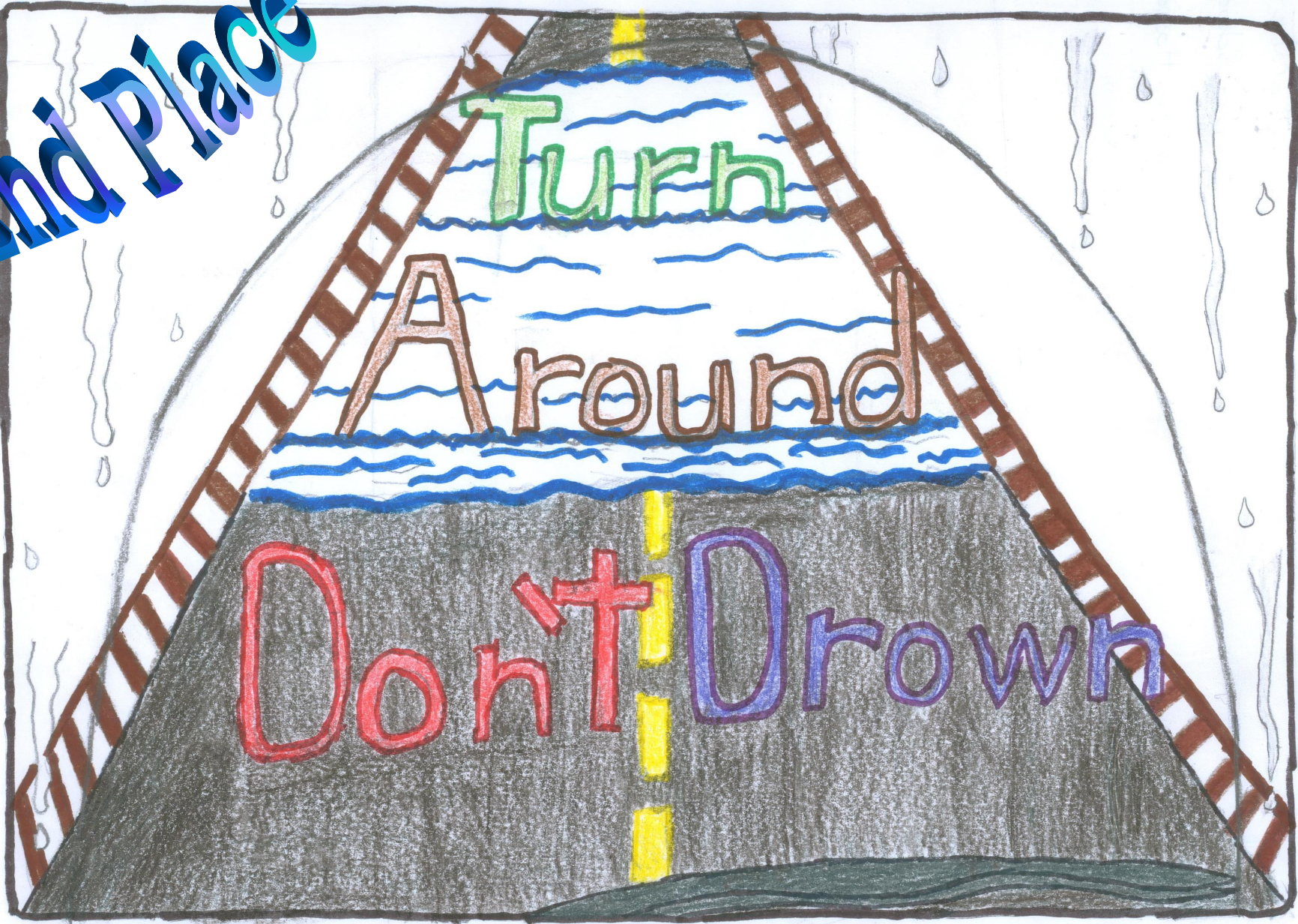

Sean Cervantes  
Bosque School  
Albuquerque



# June 2016

## Schedule of Events

### [Training](#)

 [FEMA EMI](#)

<http://training.fema.gov/>

6/20—6/23

E0172 Hazus-MH for Flood

6/27—6/30

E0273 Managing Floodplain  
Development thru the NFIP

Sun	Mon	Tue	Wed	Thu	Fri	Sat
			1	2	3	4
5 DOUGHNUT DAY	6 D-DAY	7	8	9	10	11
12	13	14 FLAG DAY	15	16	17	18
19 FATHERS DAY	20 JUNE SOLSTICE	21	22	23	24	25
2016 ASFPM Conference "Great Lakes—Grand Partners" - Grand Rapids, Michigan						
26	27	28	29	30		





Ethan Flores  
Sunrise Elementary School  
Las Cruces



# July 2016

## Schedule of Events

### Training

☔ FEMA EMI  
<http://training.fema.gov/>

7/11—7/14  
 E0282 Advanced Floodplain  
 Management Concepts II

7/18—7/21  
 E0190 ArcGIS for Emergency  
 Managers

7/18—7/21  
 E0278 NFIP/Community Rating  
 System

Sun	Mon	Tue	Wed	Thu	Fri	Sat
			1		1	2
3	4 INDEPENDENCE DAY	5	6	7	8	9
10	11	12	13	14	15	16
17	18	19	20	21	22	23
24 PARENTS' DAY	25	26 PARENT'S DAY	27	28	29	30





Analia Sanchez  
Sunrise Elementary School  
Las Cruces



# August 2016

## Schedule of Events

[Training](#)

[FEMA EMI](#)

<http://training.fema.gov/>

8/22—8/25

E0241 Cooperating Technical  
Partners: Special Topics

Sun	Mon	Tue	Wed	Thu	Fri	Sat
	1	2	3	4	5	6
7	8	9	10	11	12	13
14	15	16	17	18	19	20
21 <b>SENIOR CITIZENS DAY</b>	22	23	24	25	26	27
28	29	30	31			





Makaila Cleveland  
Clovis Christian School  
Clovis



# September 2016

## Schedule of Events

### Training

 [FEMA EMI](http://training.fema.gov/)

<http://training.fema.gov/>

9/12—9/15

E0312 Fundamentals of  
Building Science

9/12—9/15

E0273 Managing Floodplain  
Development thru the NFIP

9/19—9/22

E0278 NFIP Community  
Rating System

Sun	Mon	Tue	Wed	Thu	Fri	Sat
				1	2	3
4	5 <b>LABOR DAY</b>	6	7	8	9	10
11 PATRIOT DAY  NATIONAL GRANDPARENTS DAY	12	13	14	15	16 CONSTITUTION DAY	17
18	19	20	21	22 SEPT. EQUINOX	23	24
25	26	27	28	29	30	

NMFMA FALL WORKSHOP  
Deming, NM





Ciara Quezada  
Sunrise Elementary School  
Las Cruces



# October 2016

## Schedule of Events

\*\*\*NO SCHEDULED EVENTS\*\*\*

Sun	Mon	Tue	Wed	Thu	Fri	Sat
						1
2	3	4	5	6	7	8
9	10 COLUMBUS DAY	11	12	13	14	15
16	17 BOSS'S DAY	18	19	20	21	22
23	24	25	26	27	28	29
30	31 HALLOWEEN					





Josie Vesbach  
Bosque School  
Albuquerque



# November 2016

## Schedule of Events

\*\*\*NO SCHEDULED EVENTS\*\*\*

Sun	Mon	Tue	Wed	Thu	Fri	Sat
		1 DAYLIGHT SAVING TIME ENDS	2	3 ELECTION DAY	4	5
6	7	8 ELECTION DAY	9	10	11 VETERANS DAY	12
13	14	15	16	17	18	19
20	21	22	23	24 THANKSGIVING DAY	25 BLACK FRIDAY	26
27	28 CYBER MONDAY	29	30			



WARNING FLOODED

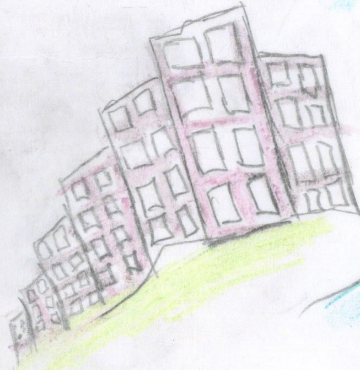

TURN AROUND DON'T

DROWN!!



# December 2016

## Schedule of Events

\*\*\*NO SCHEDULED EVENTS\*\*\*

Sun	Mon	Tue	Wed	Thu	Fri	Sat
		1	2	3	4	5
6	7 PEARL HARBOR REMEMBERANCE DAY	8	9	10	11	12
13	14	15	16	17	18	19
20	21 DECEMBER SOLSTICE	22	23	24 CHRISTMAS EVE	25 CHRISTMAS DAY	26
27	28	29	30	31 NEW YEAR'S EVE		



Jaxon Odom  
Clovis Christian School  
Clovis

3rd Place

Turn  
Around

Don't Drown





# January 2017

## Schedule of Events

\*\*\*NO SCHEDULED EVENTS\*\*\*

Sun	Mon	Tue	Wed	Thu	Fri	Sat
1 NEW YEAR'S DAY	2	3	4	5	6	7
8	9	10	11	12	13	14
15	16 MARTIN LUTHER KING DAY	17	18	19	20	21
22	23	24	25	26	27	28
29	30	31				



## Disaster Services—Your Family Disaster Plan

Disaster can strike quickly and without warning. It can force you to evacuate your neighborhood or confine you to your home. What would you do if basic services—water, gas, electricity or telephones—were cut off? Local officials and relief workers will be on the scene after a disaster, but they cannot reach everyone right away.

Families can—and do—cope with disaster by preparing in advance and working together as a team. Follow the steps listed below to create your family's disaster plan. Knowing what to do is your best protection and your responsibility.

### 4 Steps to Safety

#### 1. Find Out What Could Happen to You

- ☛ Contact your local Red Cross chapter or emergency management office—be prepared to take notes.
- ☛ Ask what types of disasters are most likely to happen. Request information on how to prepare for each.
- ☛ Learn about your community's warning signals: what they sound like and what you should do when you hear them.
- ☛ Ask about animal care after a disaster. Animals are not allowed inside emergency shelters because of health regulations.
- ☛ Find out how to help elderly or disabled persons, if needed.
- ☛ Find out about the disaster plans at your workplace, your children's school or day care center, and other places where your family spends time.

#### 2. Follow these steps to create your family's disaster plan

- ☛ Meet with your family and discuss why you need to prepare for disaster. Explain the dangers of fire, severe weather, and earthquakes to children. Plan to share responsibilities and work together as a team.
- ☛ Discuss the types of disasters that are most likely to happen. Explain what to do in each case.
- ☛ Pick two places to meet:
  - \*\*Outside your home or a neighbors house, school, church, etc. in case of a sudden emergency, like a fire
- ☛ Ask an out of State friend to be your "family contact". After a disaster, it's often easier to call long distance. Other family members should call this person and tell them where they are. Everyone must know your contact's phone number.
- ☛ Discuss what to do in an evacuation. Plan how to take care of your pets.

#### 3. Complete This Checklist

- ☛ Post emergency telephone numbers by phones (fire, police, ambulance, etc.)
- ☛ Teach children how and when to call 9-1-1 or your local Emergency Medical Services number for emergency help.
- ☛ Show each family member how and when to turn off the water, gas, and electricity at the main switches.
- ☛ Check if you have adequate insurance coverage.
- ☛ Get training from the fire department for each family member on how to use the fire extinguisher (ABC type), and show them where it's kept.
- ☛ Install smoke detectors on each level of your home, especially near bedrooms.
- ☛ Conduct a home hazard hunt.
- ☛ Stock emergency supplies and assemble a Disaster Supply Kit.
- ☛ Take a Red Cross first aid and CPR class.
- ☛ Determine the best escape routes from your home. Find two ways out of each room.
- ☛ Find the safe places in your home for each type of disaster.

#### 4. Practice and Maintain Your Plan

- ☛ Quiz your kids every six months so.
- ☛ Conduct fire and emergency evacuation.
- ☛ Replace stored water every six months and stored food every six months.
- ☛ Test and recharge your fire extinguisher (s) according to manufacturer's instructions.
- ☛ Test your smoke detectors monthly and change the batteries at least once a year.

## Basic Disaster Supplies

There are six basics you should stock in your home:

- [Water](#)

- [Food](#)

Note: Be sure to include a manual can opener.

- ☛ Ready-to-eat canned meats, fruits and vegetables
- ☛ Canned juices, milk, soup (if powdered, store extra water)
- ☛ Staples--sugar, salt, pepper
- ☛ High energy foods--peanut butter, jelly, crackers, granola bars, trail mix
- ☛ Vitamins
- ☛ Foods for infants, elderly persons or persons with special dietary needs
- ☛ Comfort/stress foods--cookies, hard candy, sweetened cereals, lollipops, instant coffee, tea bags

- [First aid supplies](#)

- |   |  |
|---|--|
| ☛ Sterile adhesive bandages in assorted sizes | ☛ Needle                                     |
| ☛ 2-inch sterile gauze pads (4-6)             | ☛ Tweezers                                   |
| ☛ 4-inch sterile gauze pads (4-6)             | ☛ Antiseptic                                 |
| ☛ Hypoallergenic adhesive tape                | ☛ Thermometer                                |
| ☛ Triangular bandages (3)                     | ☛ Tongue blades (2)                          |
| ☛ 2-inch sterile roller bandages (3 rolls)    | ☛ Tube of petroleum jelly or other lubricant |
| ☛ 3-inch sterile roller bandages (3 rolls)    | ☛ Assorted sizes of safety pins              |
| ☛ Scissors                                    | ☛ Cleansing agent/soap                       |
| ☛ Tweezers                                    | ☛ Latex gloves (2 pair) & Sunscreen          |

#### Non-prescription drugs

- ☛ Aspirin or non-aspirin pain reliever
- ☛ Anti-diarrhea medication
- ☛ Antacid (for stomach upset)
- ☛ Syrup of Ipecac (use to induce vomiting if advised by the Poison Control Center)
- ☛ Laxative
- ☛ Activated charcoal (use if advised by the Poison Control Center)

- [Clothing, bedding and sanitation supplies](#)

- [Tools](#)

- [Special items](#)

Keep the items that you would most likely need during an evacuation in an easy-to-carry container. Possible containers include a large, covered trash container; a camping backpack; or a duffel bag.

For more information:

<http://www.fema.gov>

<http://www.ready.gov>





# NMFMA 2017 FLOOD AWARENESS CALENDAR CONTEST Entries Due by November 1, 2016

Here's your chance to show off your talent, win cash and help New Mexican's with Flood Awareness. Just check the NMFMA web site for deadlines and other information.

<http://www.nmfma.org/>

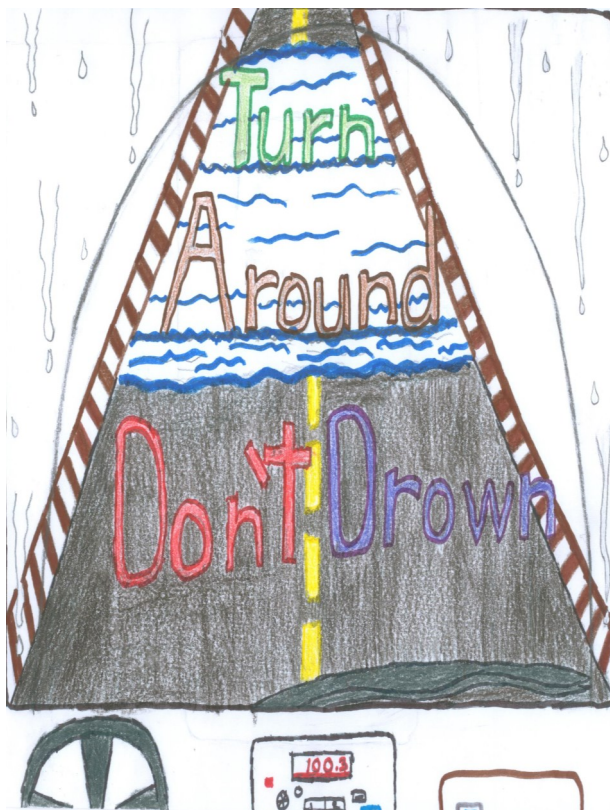

Open to all New Mexico 3rd thru 6th grade students, public, private, parochial and home school.

Cash prizes awarded to the schools of students chosen for 1st—3rd places.

## **RULES:**

- Use only 8.5 x 11 inch, white paper or poster board. Other sizes will not be judged.
- Must be students original artwork.
- No syndicated or copyrighted characters will be accepted.
- No computer aided or copy machine entries will be accepted.
- Reproducibility of the artwork will be a factor in the judge's decisions, so use contrasting and bright colors.
- All entries become the property of the New Mexico Floodplain Managers Association (NMFMA). The right to modify any poster for reproduction is reserved.
- Attach entrant information on the back of artwork; upper right hand corner.  
(Student Name, Grade, School Name, Teacher, School Address, School Phone Number)



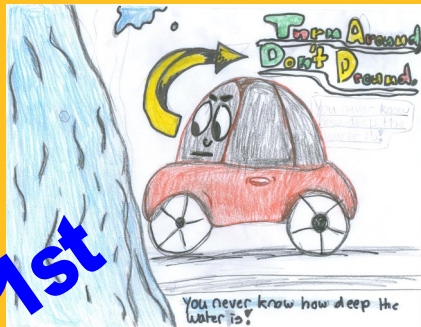

1st

JANUARY

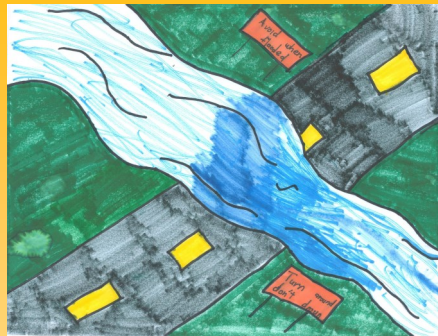

FEBRUARY



MARCH



APRIL



MAY

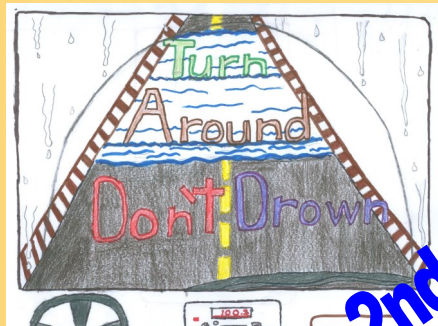

JUNE

2nd



JULY



AUGUST



SEPTEMBER



OCTOBER



NOVEMBER

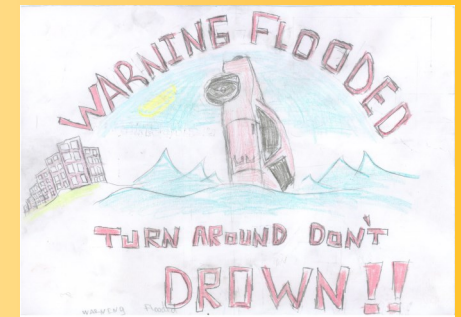

DECEMBER



This project was funded through the Department of Homeland Security & Emergency Management (DHSEM) Preparedness Bureau and FEMA under the Community Assistance Program/State Support Services Element (CAP/SSSE) with the New Mexico Floodplain Managers Association (NMFMA) providing the cost share. All prizes awarded by NMFMA are separate from funding for the printing of the calendar and were provided solely by NMFMA. Points of view or opinions expressed in this document are those of the authors and do not necessarily represent the official position or policies of the NMDHSEM, FEMA or the U.S. Department of Homeland Security



3rd

JANUARY 2017